

1 1.23. HST-SL-Console – Lift-up Sliding Door-Heavy Load Bracket

- for mounting underneath floor-depth elements, in particular lift-up sliding doors
- simple and fast mounting in case of an already existing insulating layer
- offers high load transference
- secure fixing of the window to the concrete floor
- maximum load tested by ift-Rosenheim

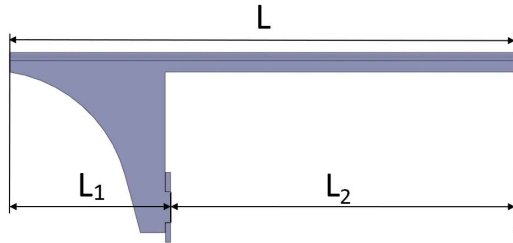
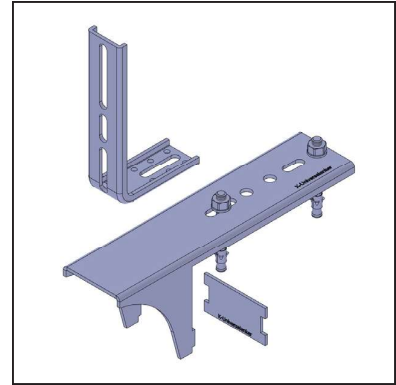

Dimensions, see table

HST-SL-Console with connecting angle and heavy-duty dowels

Article-No.	Article name [mm]	L [mm]	L1 [mm]	L2 [mm]	Units
K-405216	HST-SL-Console 250-80 - Set	250	80	170	5
K-405217	HST-SL-Console 300-125 - Set	300	125	175	5
K-405218	HST-SL-Console 350-175 - Set	350	175	175	5
K-405219	HST-SL-Console 400-225 - Set	400	225	175	5

Scope of delivery per item: 1x HST-SL-Console, 1x HST-SL-Protection Plate, 1x Connecting Angle-65x145x3,0, 2x Heavy-Duty Dowel Ø8x71

Article-No.	Article name [mm]	L [mm]	L1 [mm]	L2 [mm]	Units
K-40521410	HST-SL-Konsole 250-80	250	80	170	5
K-40521420	HST-SL-Konsole 300-125	300	125	175	5
K-40521430	HST-SL-Konsole 350-175	350	175	175	5
K-40521440	HST-SL-Konsole 400-225	400	225	175	5

Scope of delivery per item: 1x HST-SL-Console, 1x HST-SL-Protection Plate

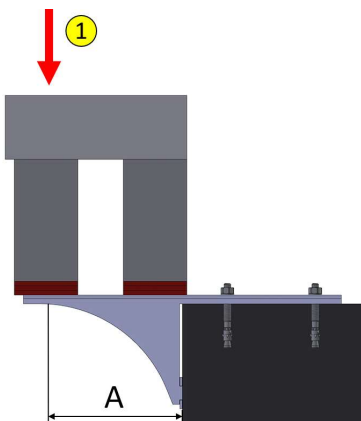

ift-Rosenheim verification number

Tested for loads in the window layer:

17-001190-PR01 PB 04-K26-09-de-01, 18-003796-PR04 PB-K26-09-de-01

	overhang A	maximum load
1	50 mm	622 kg
	95 mm	622 kg
	145 mm	551 kg
	195 mm	284 kg

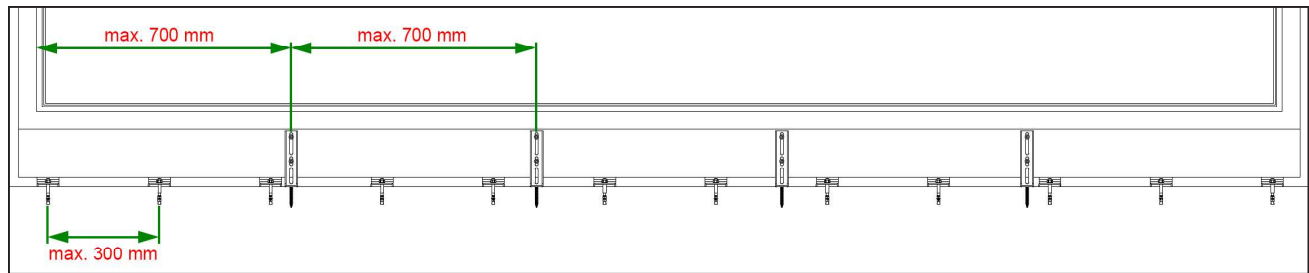

mounting distance; tested measurements

Installation instruction

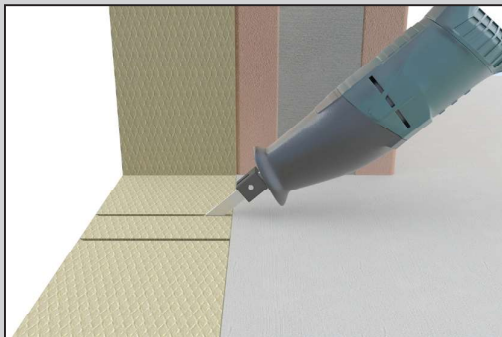

Step 1
Mark the mounting position and cut it free.



Step 2
Insert the Protection Plate. It protects soft stones and sealing from damage.



Step 3
Insert bracket into insulation. The bridges with the protection plate have to be aligned with the concrete sole. Secure it with the first Heavy-Duty Dowel.

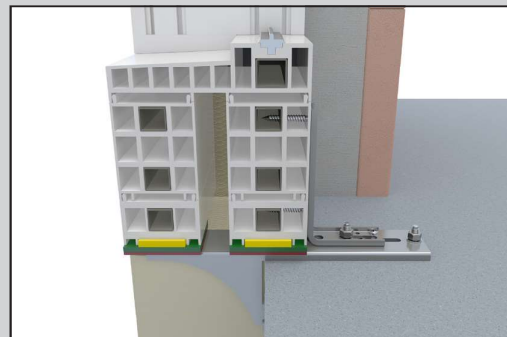

Step 4
Place second Heavy-Duty Dowel. Screw connecting angle to door element and console.

Associated products



Adjustable Blocking
page 75

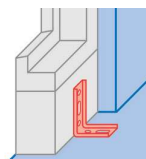

Fastening of connection profiles
page 64